



# ADAPTAFORM ADAPTABOX

BOX FORMING AND  
CLOSING MACHINES

**PANOTEC®**



## FORMING AND CLOSING

Panotec's range of packaging machinery has been complemented by two stand-alone machines:

- **the Box Forming Machine AdaptaForm**
- **the Box Closing Machine AdaptaBox**

These machines can form and close Fefco 0410\* boxes at up to **8 boxes/minute**.

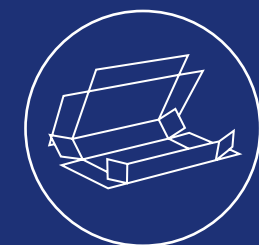



# ADAPTAFORM BOX FORMING

The AdaptaForm automatically forms the bottom of Fefco 0410\* and folds the bottom flaps of the box.

The machine is extremely adaptable and versatile, and can be set up in a number of ways to meet customers' production and space requirements:

- available as a stand-alone solution or as an integral part of a packaging line
- cardboard infeed can be handled manually, automatically from pallets or by means of a die-cutter.
- adaptable to both production in large batches and batch 1 thanks to the short setup and changeover times.

It is the perfect solution to pack items featuring high dimensional variability, low height, length and narrow width.

PRODUCTION IN  
**BATCHES** AND  
**LOT SIZE 1**

## MANUFACTURING INDUSTRIES

**Disassembled  
furniture**



**Panels**



**Shower boxes**



**Radiators**



**Profiles**



## Technical features

**Output**

L from 1300 to 2500 mm up to 8 boxes / min  
L from 400 to 1300 mm up to 10 boxes / min

**Item Sizes**

min: L 400 x W 220 x H 30 mm  
max: L 2500 x W 1200 x H 250 mm

**Box**

Fefco 0410\*

**Cardboard Thickness**

3 to 7 mm

**Operating Mode**

Stand-alone or integrated into a packaging line



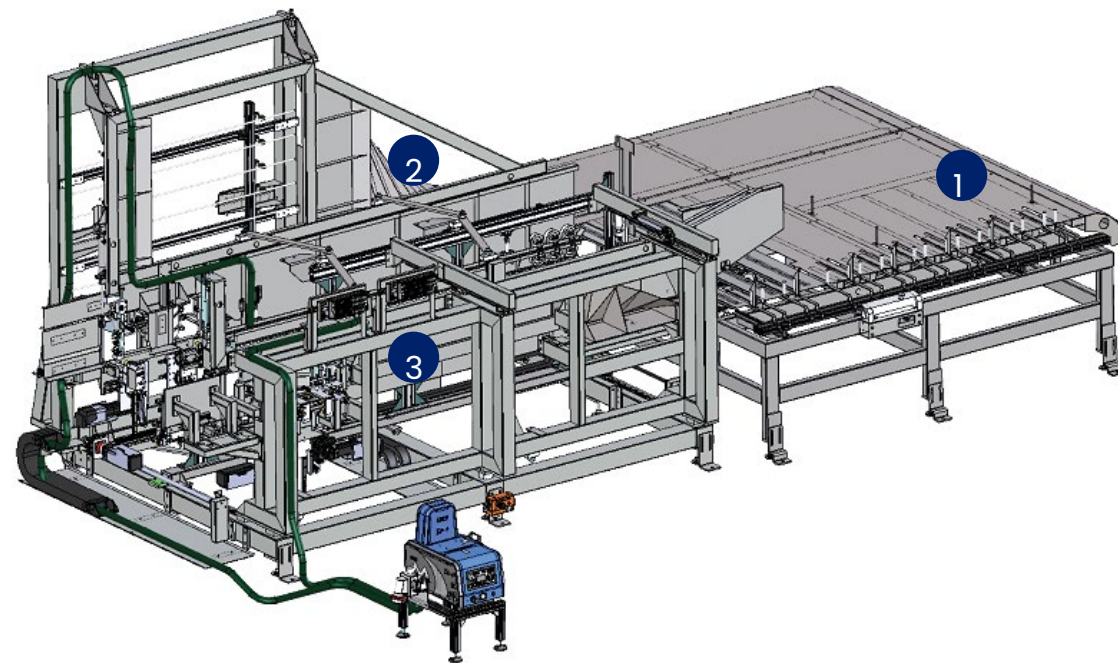

## OPERATING MODE

### 1 CENTRING AND ALIGNMENT

An automatic centering device is always provided at the infeed of the machine to ensure that the flat box is correctly aligned.

### 2 LID LIFTING SYSTEM

On the side, there is an adjustable lid-lifting system that can be fitted along the length of the box. This system lifts the lid of the box as it runs towards the forming and gluing station.

### 3 FORMING AND GLUING

The last part of the process is divided into two steps:

- the box is erected, formed and the front flap is glued with Hot-Melt glue
- the box runs on the line and the rear flap is erected, formed and glued.

Once these two steps are completed, the bottom of the box is formed and the item can be positioned inside.

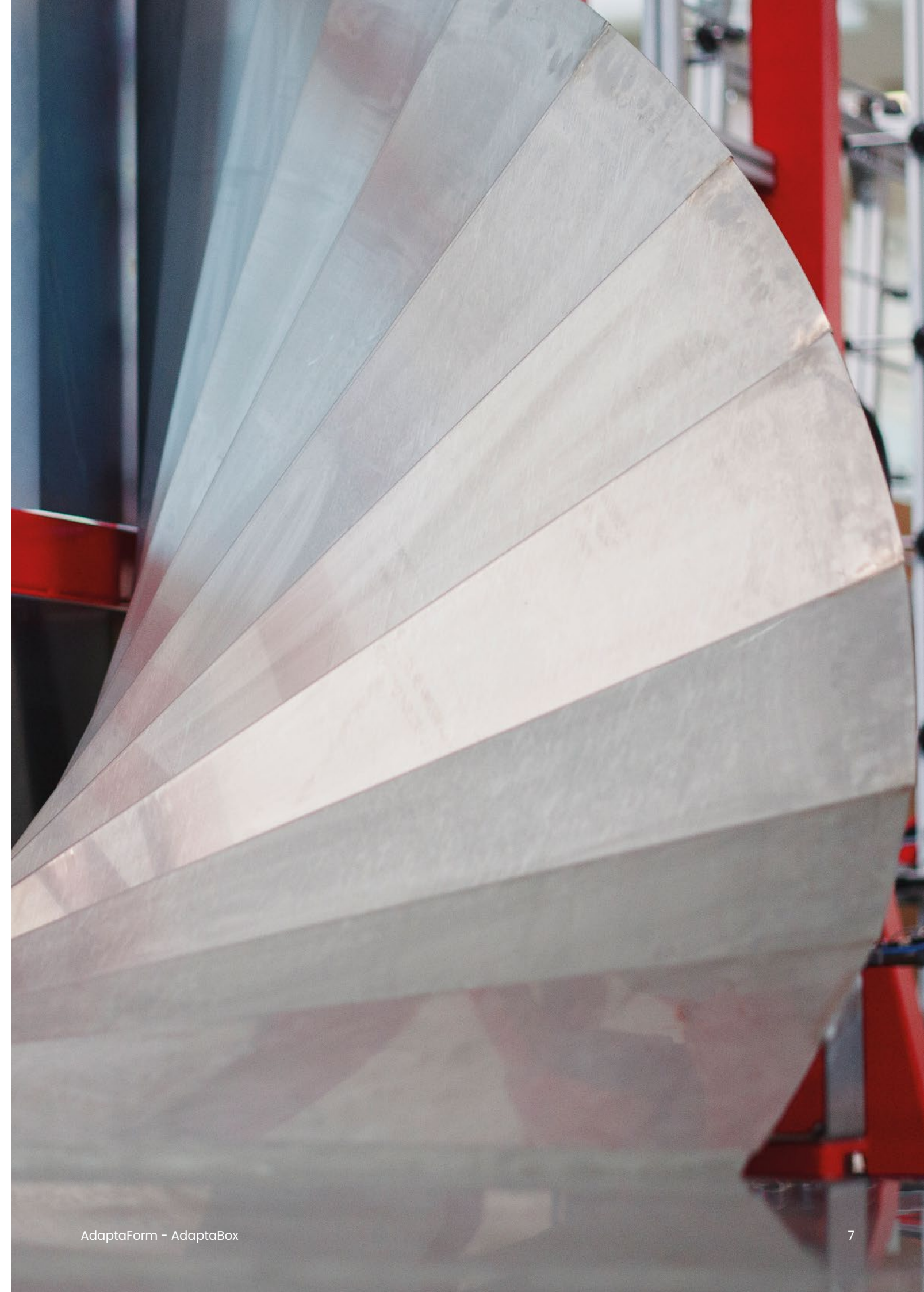

# BOX CLOSING AND FORMING UNIT

The machine automatically forms and closes long and narrow boxes.

This solution offers a great advantage in terms of modularity.

The machine can be used as a stand-alone unit or be implemented later on with other features to create a fully automatic line.

It is the perfect solution for packaging items featuring high dimensional variability, low height, length and narrow width.

Output	up to 6 boxes/minute
Item Sizes	min: L 400 x W 100 x H 15 mm max: L 2500 x W 1200 x H 100 mm
Box	Fefco 0401*
Cardboard Thickness	2 to 6 mm

## MANUFACTURING INDUSTRIES

Disassembled furniture



Panels



Shower boxes



Radiators



Profiles

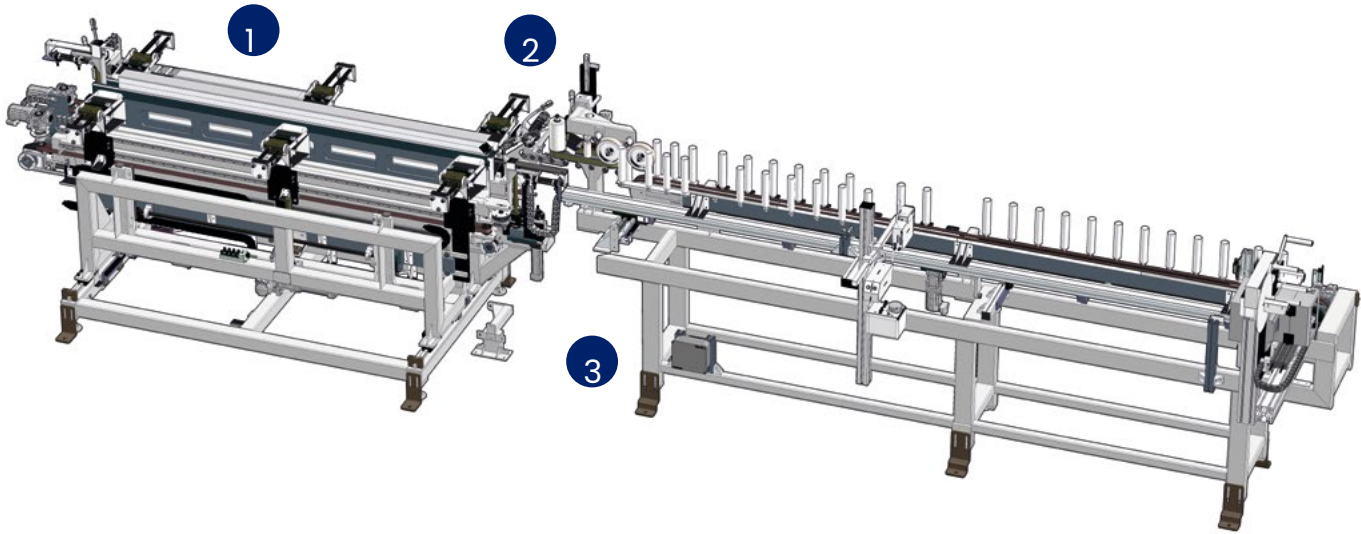

## OPERATING MODE

### 1 FORMING OF THE TRAY

The sides are erected and the side and upper flaps closed.

### 2 GLUING

Depending on the type of box, the parcel runs on the line and is either glued or taped and then conveyed to the next station.

### 3 CLOSING

The box is automatically closed at the top, in the centre of the box.



# ADAPTABOX BOX CLOSING

The AdaptaBox machine automatically closes Fefco 0410\* cardboard boxes and similar formats using Hot-Melt glue, providing perfect closure for boxes of different sizes in real time without capacity drop.  
All format changes are handled automatically, WITHOUT DOWNTIME, and can be managed from a PC fitted on the control panel.

The machine is extremely flexible and modular, so that it can be adapted to all operational needs:

- available as a stand-alone solution or as an integral part of a packaging line
- adaptable to both production in large batches and batch size 1

It is the perfect solution for packaging items featuring high dimensional variability, low height, length and narrow width.

PRODUCTION IN  
BATCHES AND  
LOT SIZE 1

## MANUFACTURING INDUSTRIES

Disassembled  
furniture



Panels



Shower boxes



Radiators



Cabinet doors,  
standard doors  
windows



Digital printing



## Technical features

Output	up to 8 boxes/minute
Processable Length (L)	400 - 2500 mm
Processable Width (W)	200 - 1200 mm
Processable Height (H)	30 - 250 mm
Box	Fefco 0410* Fefco 0427*
Cardboard Thickness	3 to 7 mm
Operating Mode	Stand-alone or integrated into a packaging line



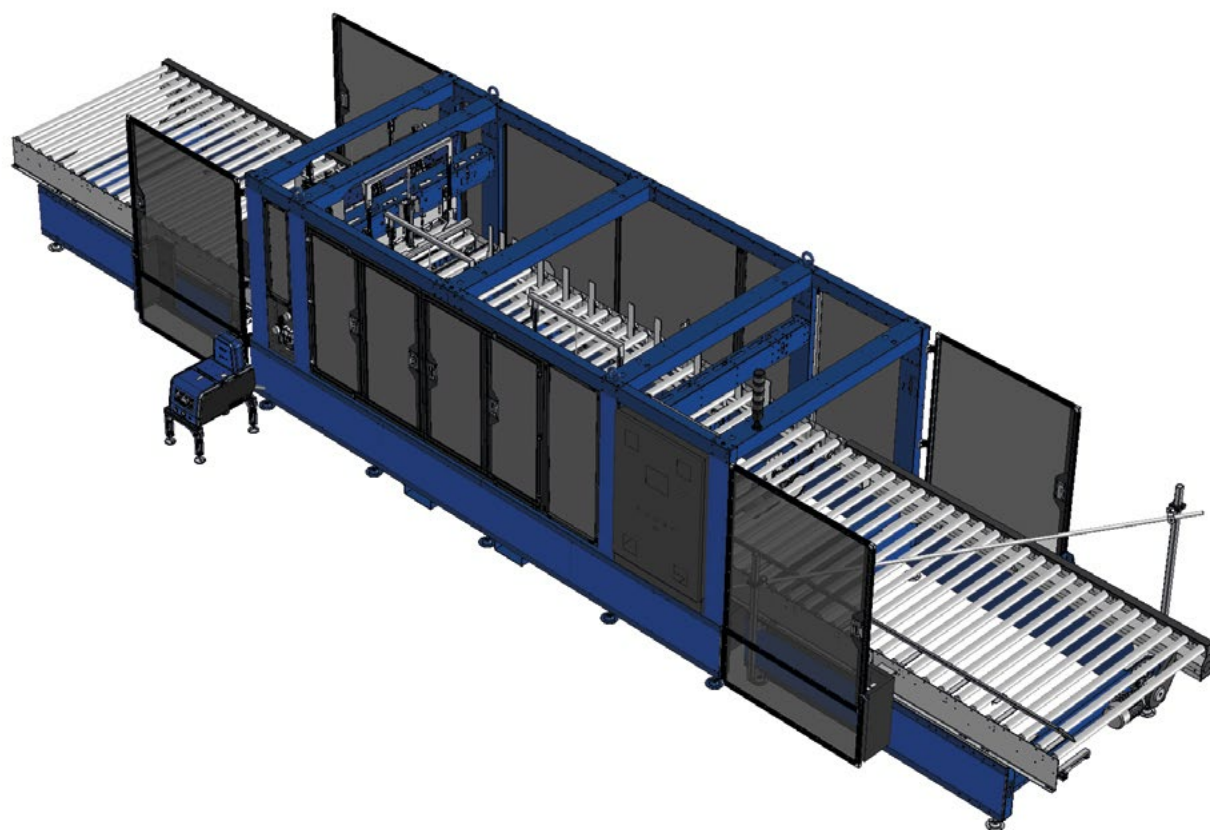

## OPERATING MODE

The line can work in batches or in flexibility and detects the size of the box automatically. An adjustable bar keeps the box correctly in place while Hot Melt glue is applied lengthwise and to the front flaps, which are then closed by two pressure devices. Lastly the flap on the back of the box is glued and closed.

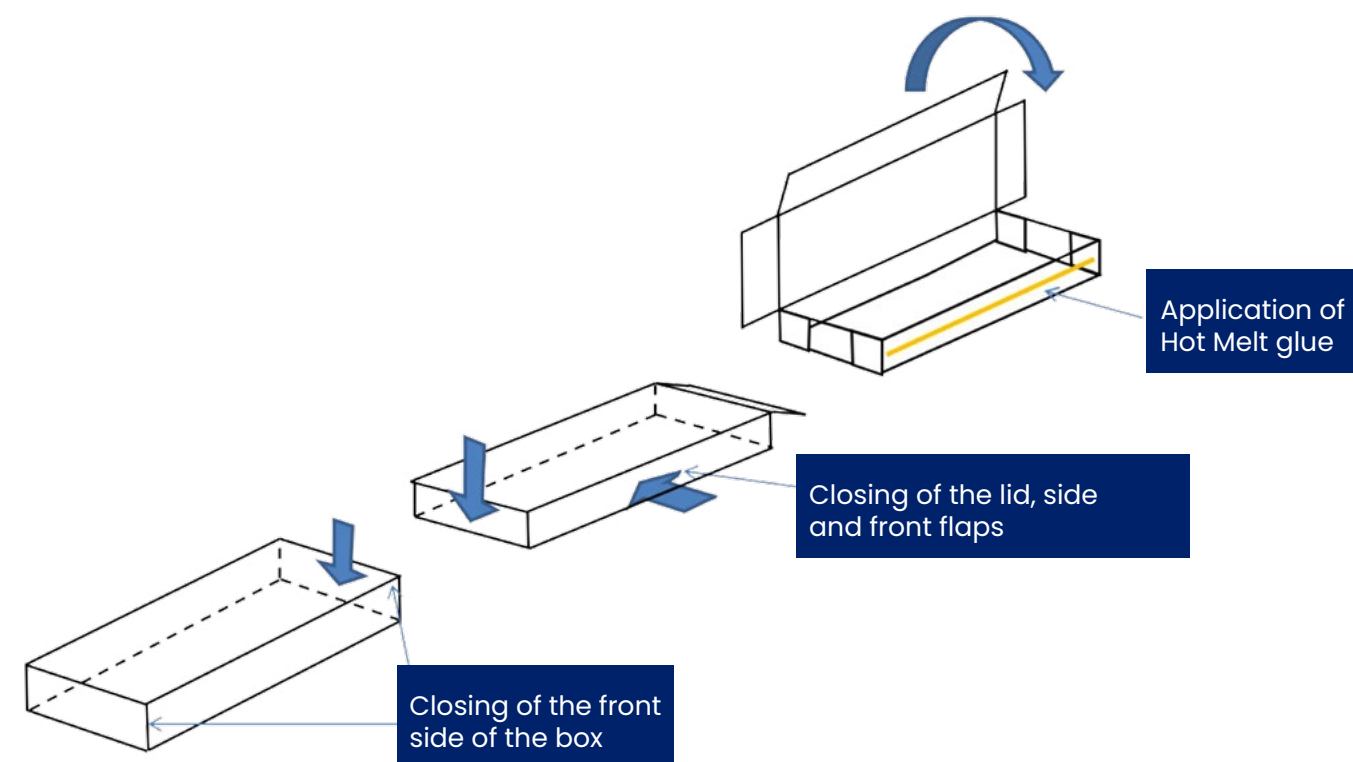
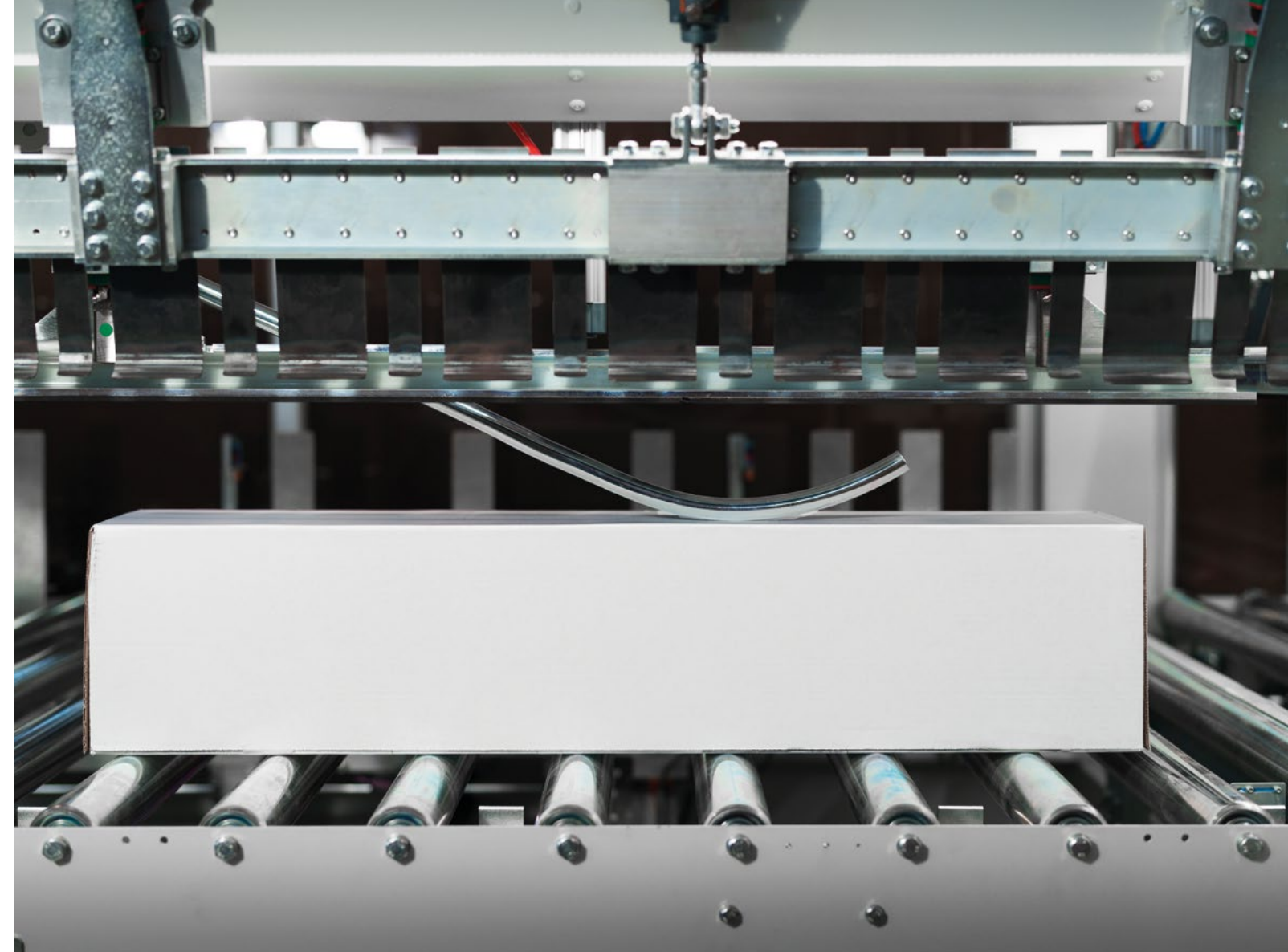



# ASSEMBLY

The best solution to assemble:

- **Cabinet Doors**
- **Frames for Wooden Doors**

Thirty years of experience are a guarantee for reliability and the highest quality standards on the market. Our assembly machines are designed to assemble all the components included on cabinet doors and door frames.

They provide a solid and perfectly assembled product at the machine outfeed, which is ready to be either fed into the production line for further processing or to be packed.

Thanks to the setup options from semi-automatic to fully automatic, the assembly machines adapt to all requirements of flexibility and production management while providing very high output rates.

**6 pieces per minute**  
**wide range of processable sizes**

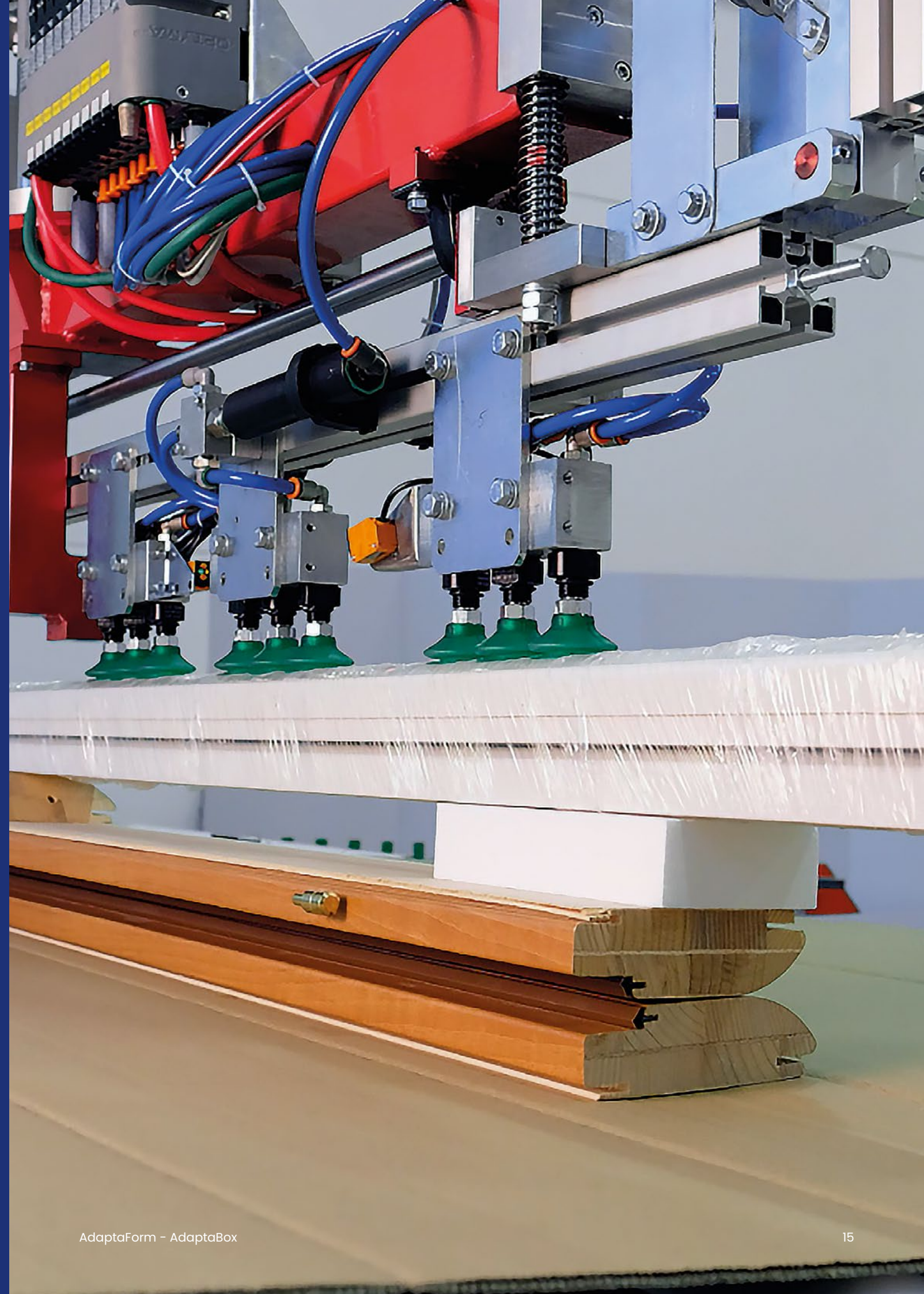



# AM3 ASSEMBLY OF CABINET DOORS

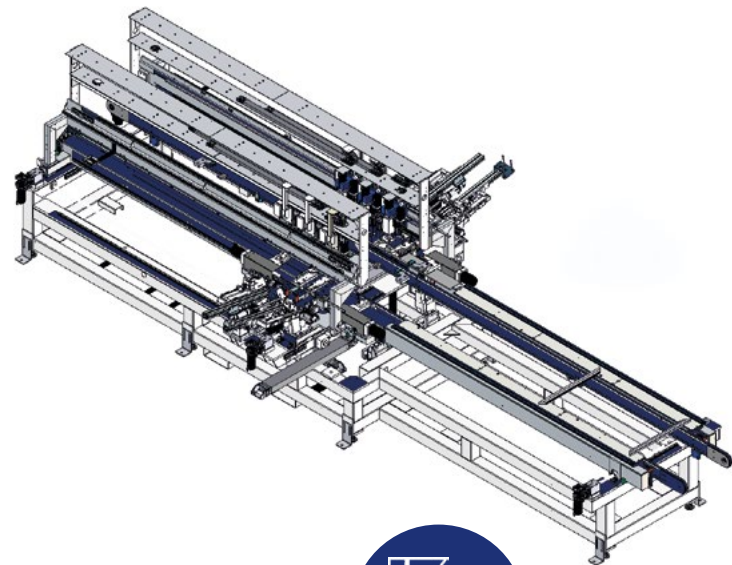

Assembles doors with 90° or 45° mitre joints



The machine can be equipped with either a fully automatic or semi-automatic feeding depending on requirements in terms of production and flexibility.

The components are assembled by applying hot melt glue dots that ensure immediate sealing of the components.

It is possible to use **adhesive Hot Melt glue** with an vibration dampening feature. A solid and perfectly assembled product is thus provided at the machine outfeed, which is ready to be processed further or to be packaged directly.

## Technical features

Processed Materials	chipboard – wood – MDF
Metre Joint	90°– 45°– 90° reversed
Output	up to 6 pieces / min
Item Sizes	min: L 300 x W 220 mm max: L 2400 x W 1000 mm

A system designed to automatically assemble doors, cabinet doors and kitchen doors made of wood or MDF with one or more panels.

# AM1 ASSEMBLY OF CABINET DOORS

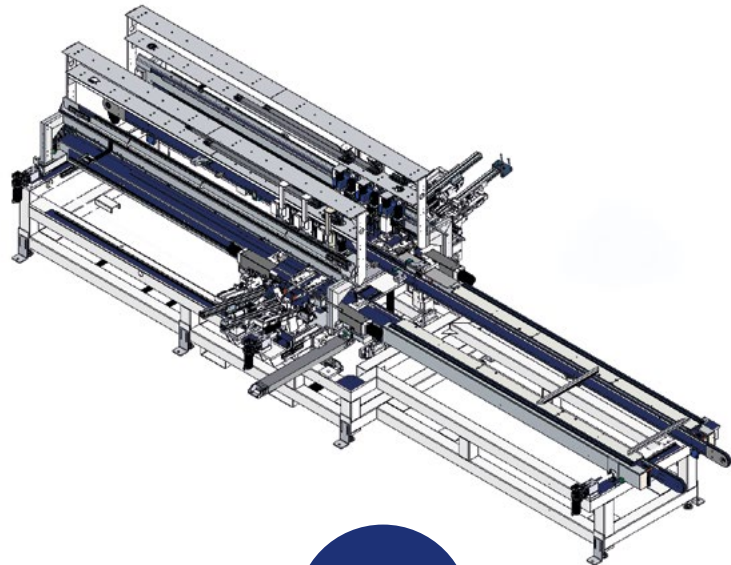

Optimised for 90° assembly



The parts are assembled using vinyl glue and Hot Melt glue which instantly seals the parts.

A glue with vibration-damping effect can also be used; this option guarantees a solid and perfectly assembled product, which is ready for further processing or packaging.

All processes can be managed automatically or semi-automatically, depending on the available resources and the required flexibility.

## Technical features

Processed Materials	chipboard – wood – MDF
Metre Joint	90°
Output	up to 6 pieces / min
Item Sizes	min: L 300 x W 220 mm max: L 2400 x W 1150 mm



# M10

## AUTOMATIC ASSEMBLY OF FRAMES FOR WOODEN DOORS

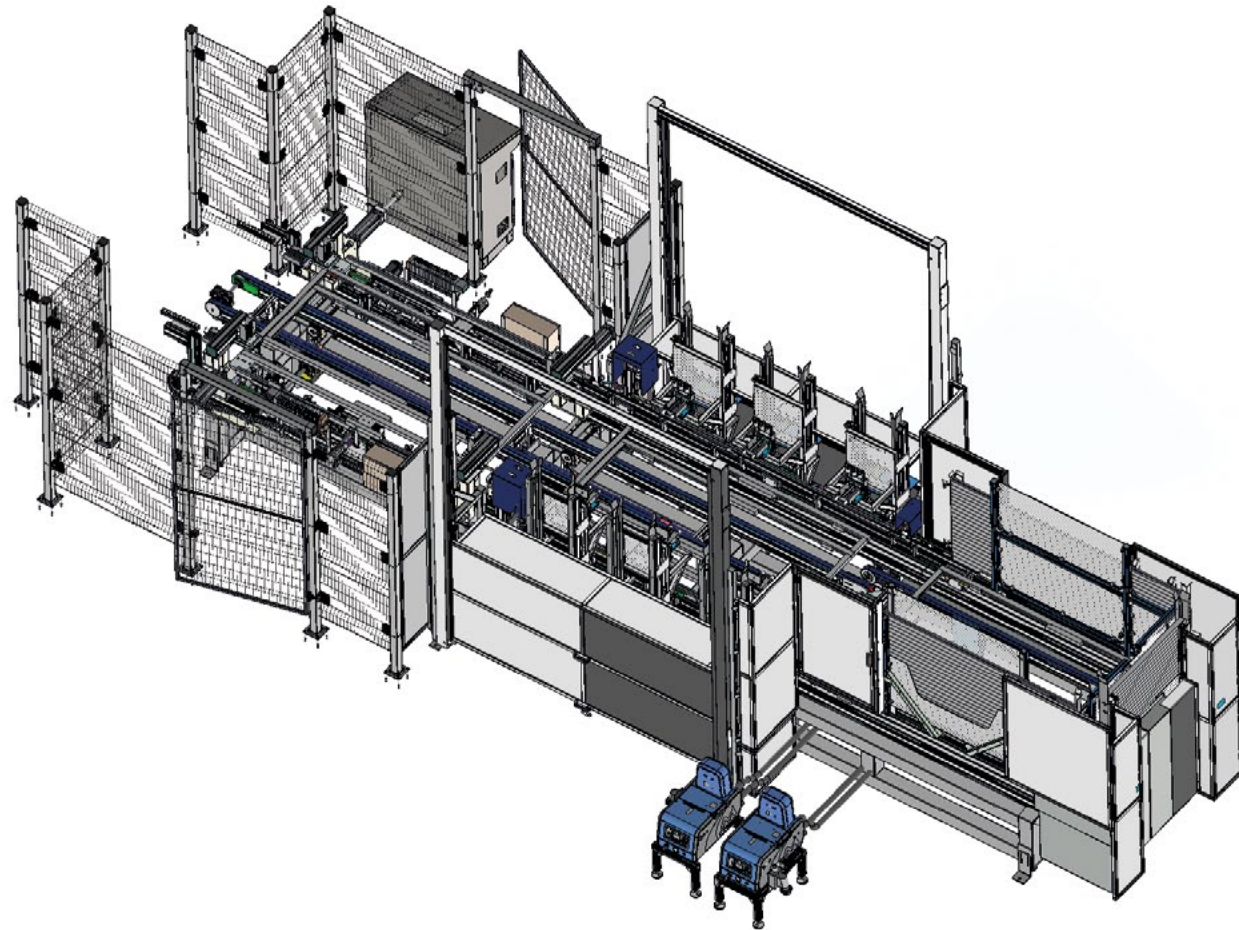

The machine automatically assembles chipboard, wood or MDF door frames.

The parts are assembled by applying **Hot Melt glue** to provide immediate sealing. Additional options include assembly by inserting locks and «Anuba» hinges.

A solid and perfectly assembled product is provided, which is ready to be fed into the production line for further processing or to be packed.

The machine can be integrated into production lines for hollow core doors or honeycomb panels.

## Technical features

Processed Materials	chipboard – wood – MDF
Metre Joint	90°
Output	up to 4 pieces / min
Item Sizes	min: L 1800 x W 600 x H 25 mm max: L 2100 x W 1100 x H 45 mm





# PANOTEC®

*Operational Headquarters*  
Via dell'Industria, 33 - 35  
41043 Formigine (MO), Italia

T +39 059 7471038  
[www.panotec.com](http://www.panotec.com)  
[info@panotec.it](mailto:info@panotec.it)



*Subject to management and coordination by International Boxes Srl*

\*Code Fefco universally adopted to  
simplify the presentation of the boxes.

06/24

